

VENTALU

Aluminium pipeline

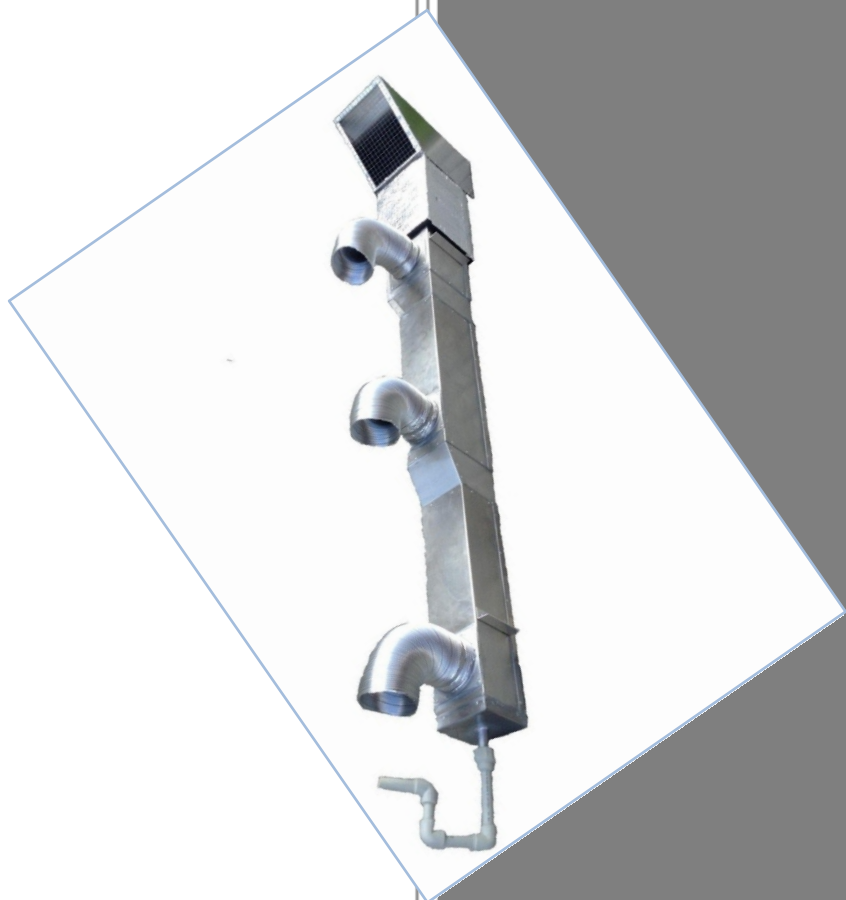

VAÑO spol. s r.o.

VENTALU

VENTALU – ventilation pipeline

from aluminium plates.

Use: - climbing ventilation irons for apartment buildings and houses, also for saunas, pools, laboratories, historical buildings, basements, damp areas ...

Advantages:

- very long lifetime (doesn't corrode)
- nonflammable
- sea water resistance (EN AW 5754),
- frost and UV illumination resistance
- excellent resistance against selected chemical species
- square shape without flanges (takes less building space in shafts)
- excellent tightness with double
- low weight (plate thickness 1 mm)
- pipeline grounding according to STN 33 0300
- vertical and horizontal position (recommended measurements (120 x 120, 140 x 140, 160 x 160, 200 x 200 a 245 x 245 mm))

Alluminium roof with

Alluminium pipeline

Alu - flexible ducts

Bottom with condensate outlet through

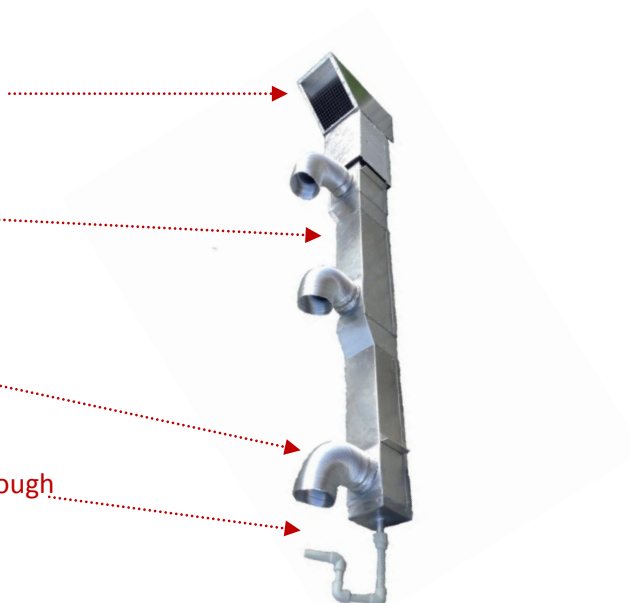

VERTICAL VENTILATION SYSTEM „VENTALU“

Use in practise:

Bottom up air outlet

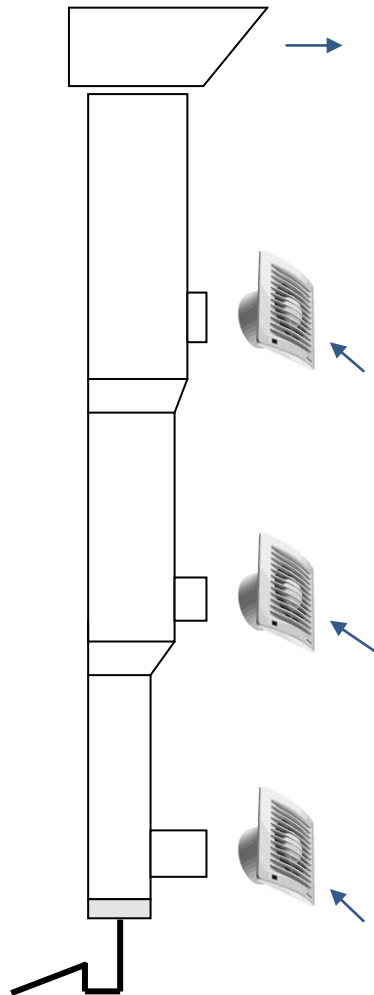

Top down air outlet

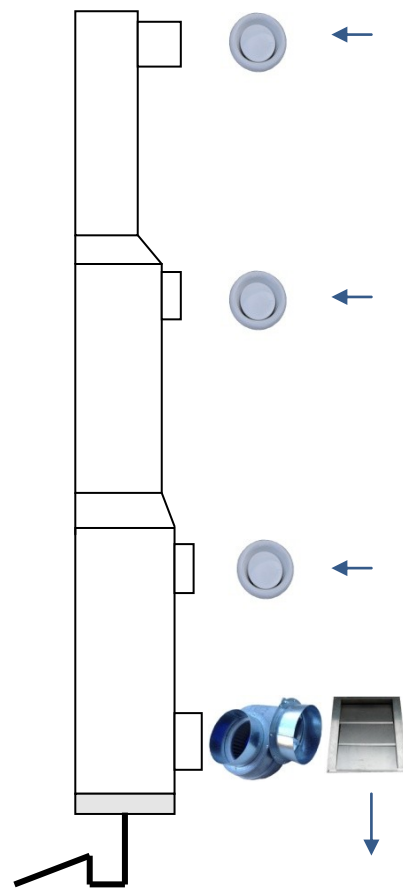

Condensate outlet 1/2"



ZONE SOUNDPROOFED APARTMENT VENTILATION WITH ALLUMINIUM PIPELINE VENTALU 140 x 140 mm AND WITH ROOF VENTILATION UNITS SJ

Example for four apartment building:

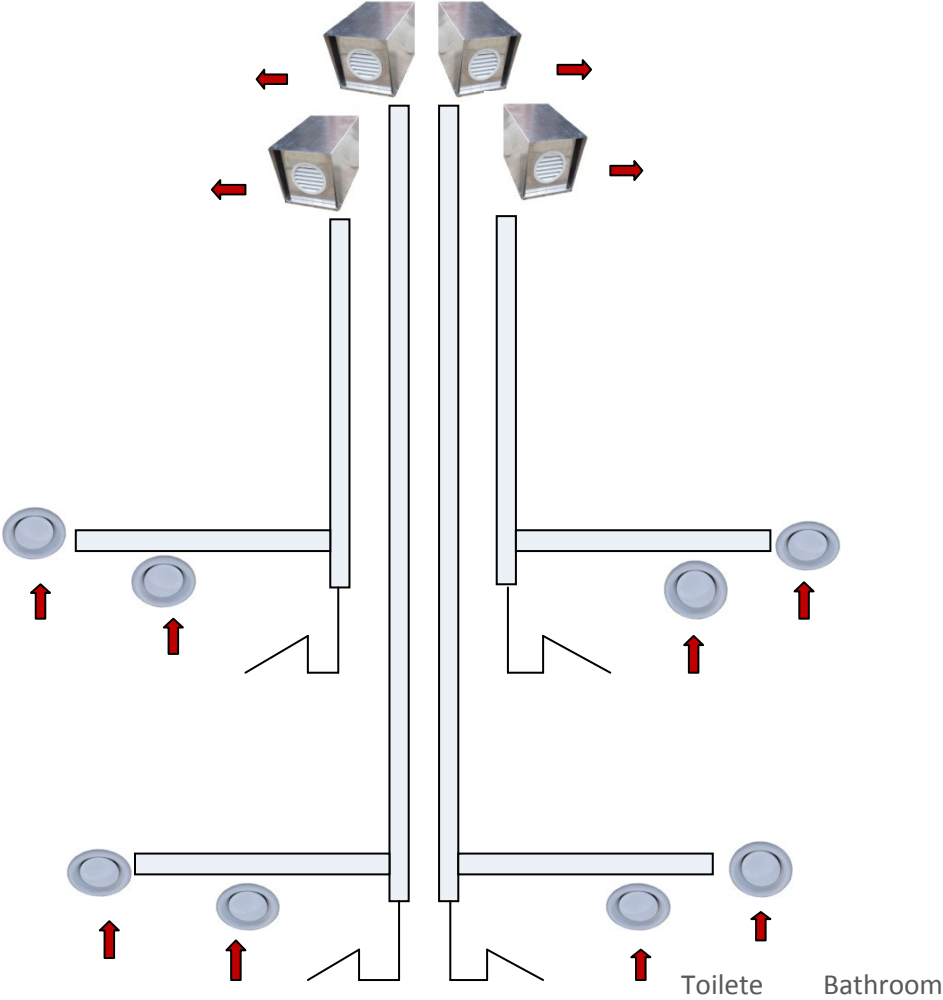

Recommended size of upper shaft:

Alluminium pipeline Ventalu 140 x 140 mm

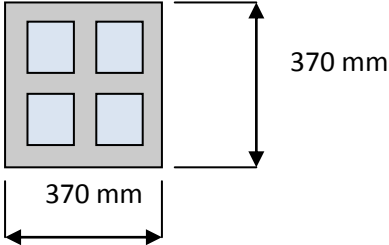

Switchboard with fuse, with time overrun via buttons and with night timing.

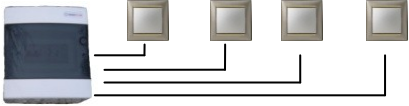

ZONE SOUNDPROOFED APARTMENT VENTILATION WITH ALLUMINIUM PIPELINE VENTALU 160 x 160 mm AND WITH FANS G (ventilation top down)

Example for four apartment building:

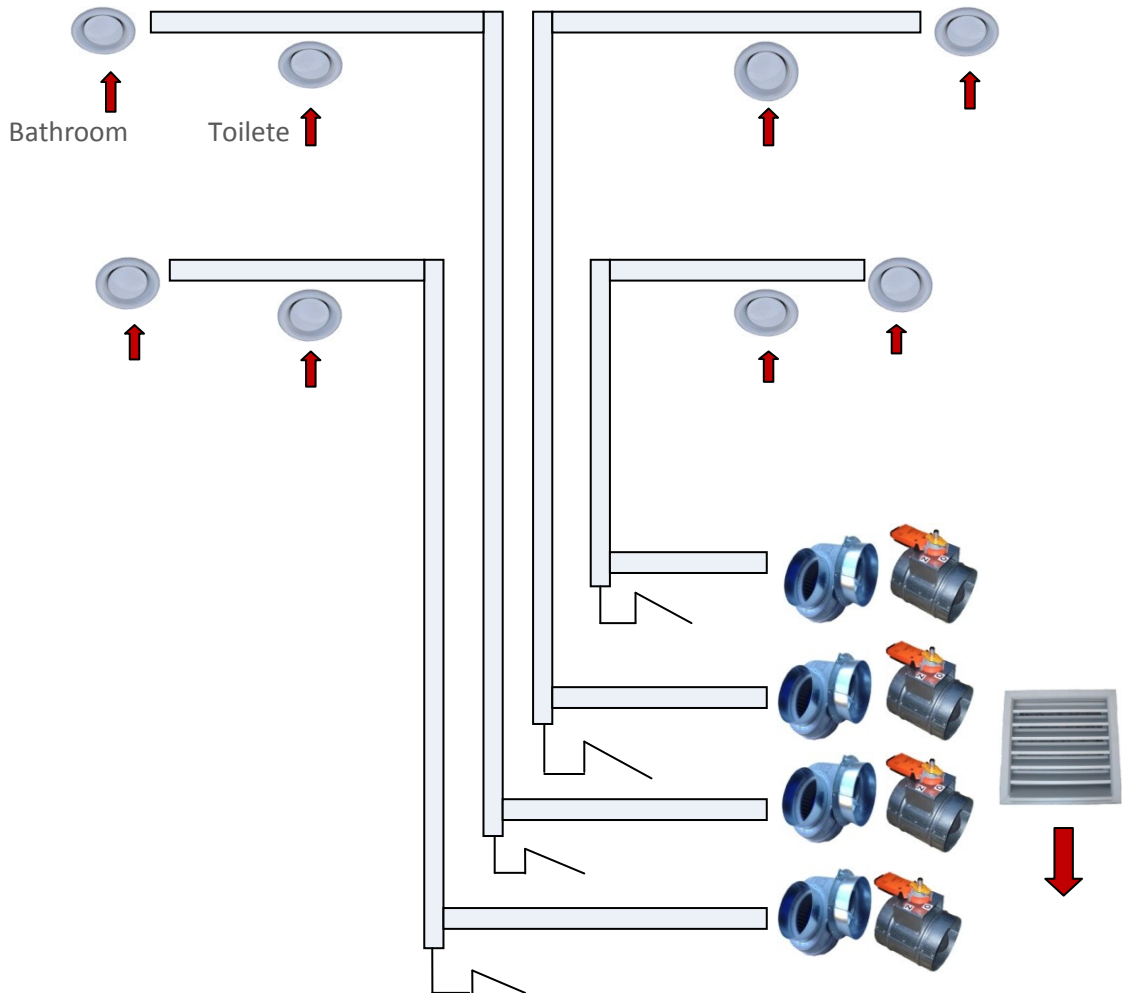

Recommendet size of lower shaft:

Alluminium pipeline Ventalu 160 x 160 mm

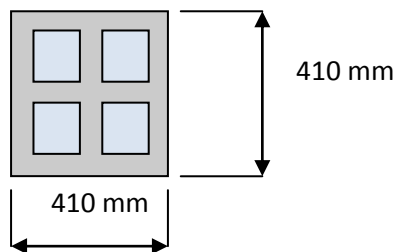

Switchboard with fuse, with time overrun via buttons and with night timing.

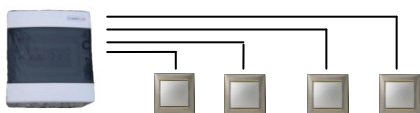

ZONE SOUNDPROOFED APARTMENT VENTILATION WITH ALLUMINIUM PIPELINE VENTALU 200 x 200 mm AND WITH ROOF VENTILATION UNITS SJ 200 PM

Example for three - apartment building :

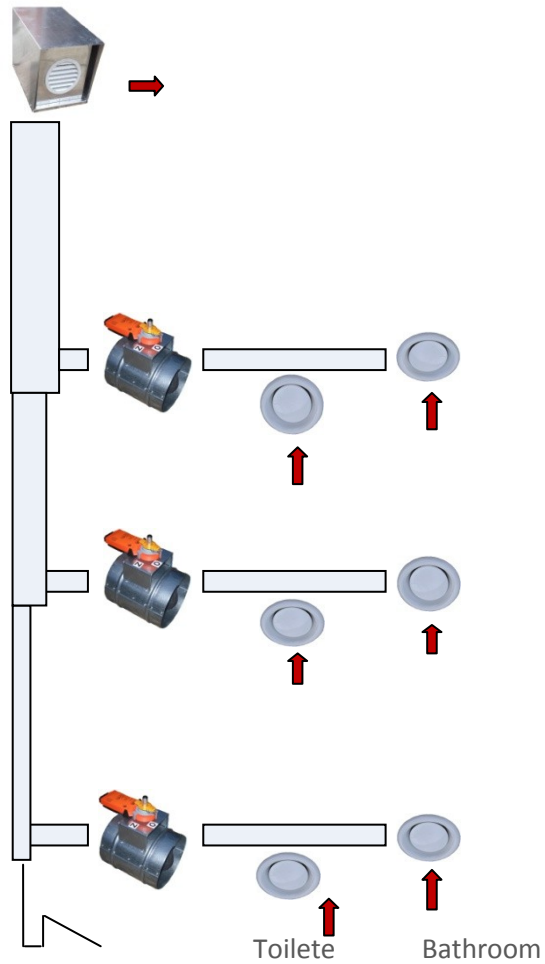

Recommended size of upper shaft:

Alluminium piping Ventalu 200 x 200 mm

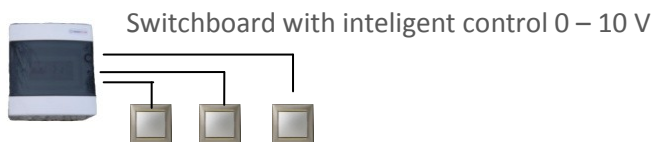
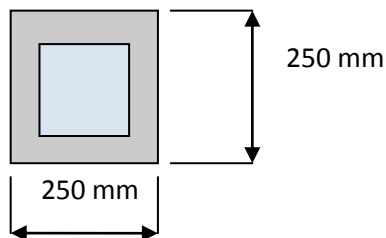

APARTMENT VENTILATION WITH ALLUMINIUM PIPELINE „VENTALU“

Example for four apartment building, with toilet ventilation under the ceiling:

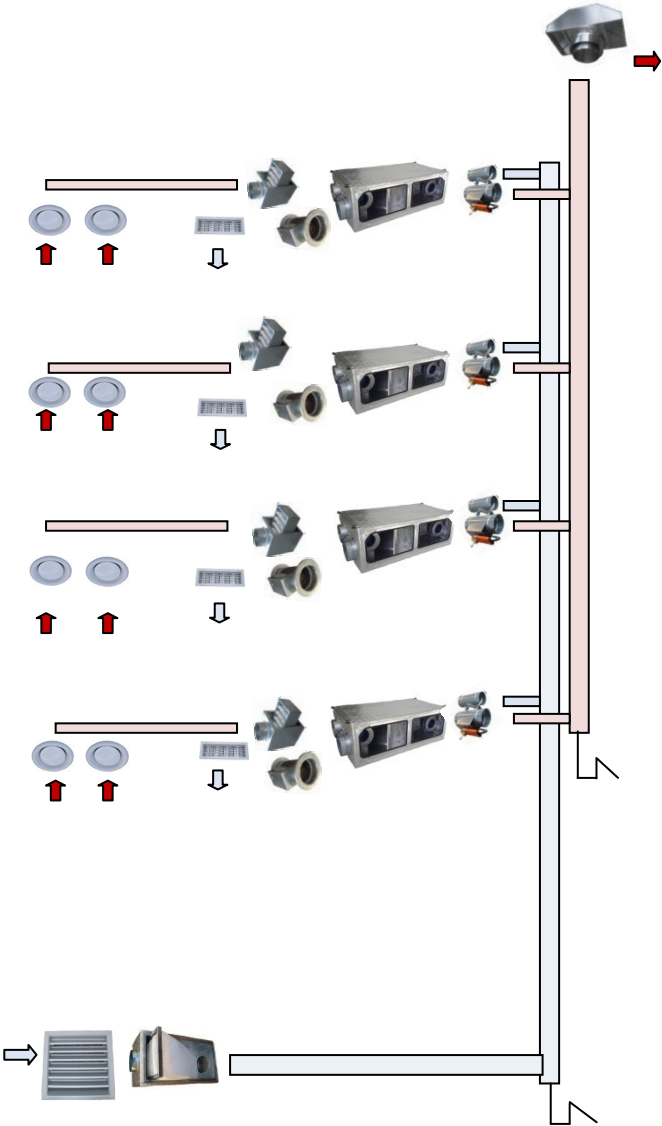

Recommended size of upper shaft:
Alluminium pipping Ventalu 200 x 200 mm

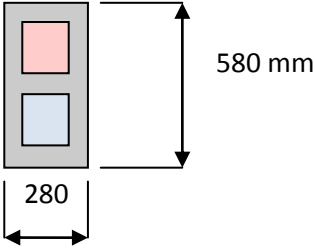

ZONEPROOFED APARTMENT VENTILATION WITH ALLUMINIUM PIPELINE

Exemple for six apartment building with G toilet fans under the ceiling:

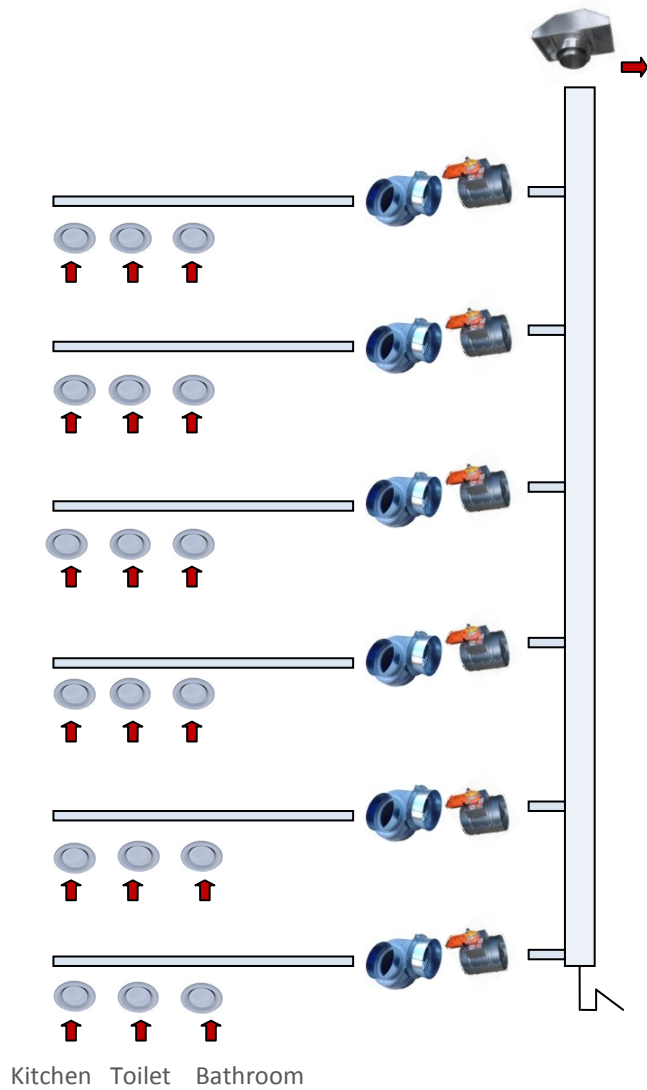

Recommended size of upper shaft:

Alluminium pipping Ventalu 245 x 245 mm

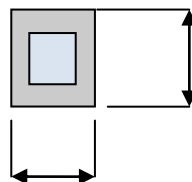

300 x 300 mm

Switchboard with fuse, with time overrun via buttons and with night timing.

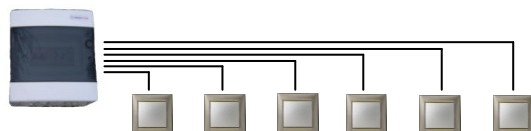

Condensate pipeline outlet

From the inside of pipeline condensation occurs during operation.

This condensate is trapped through a drain bottom ½" and then led through the siphon to the sewer.

Practice showed the need for two condensate drains on the bottom of the pipeline, where the second drainage drain serves as overflow, in case one condensate drain is blocked by building impurities.

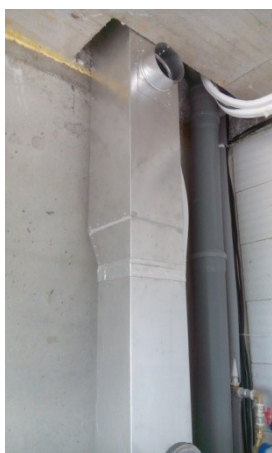

We reserve the right to change products parameters, within technical progress, without preceding warning.

Contact:

VAŇO® spol. s r.o.

Chotárna 57

SK 851 10 Bratislava

www.vano.sk

vano@vano.sk

Tel: + 421 2 4552 9340

Tel: + 421 905 993 017

Tel: + 421 905 266 747